

C112-235

Josh Lindsay

Wm Van Lear

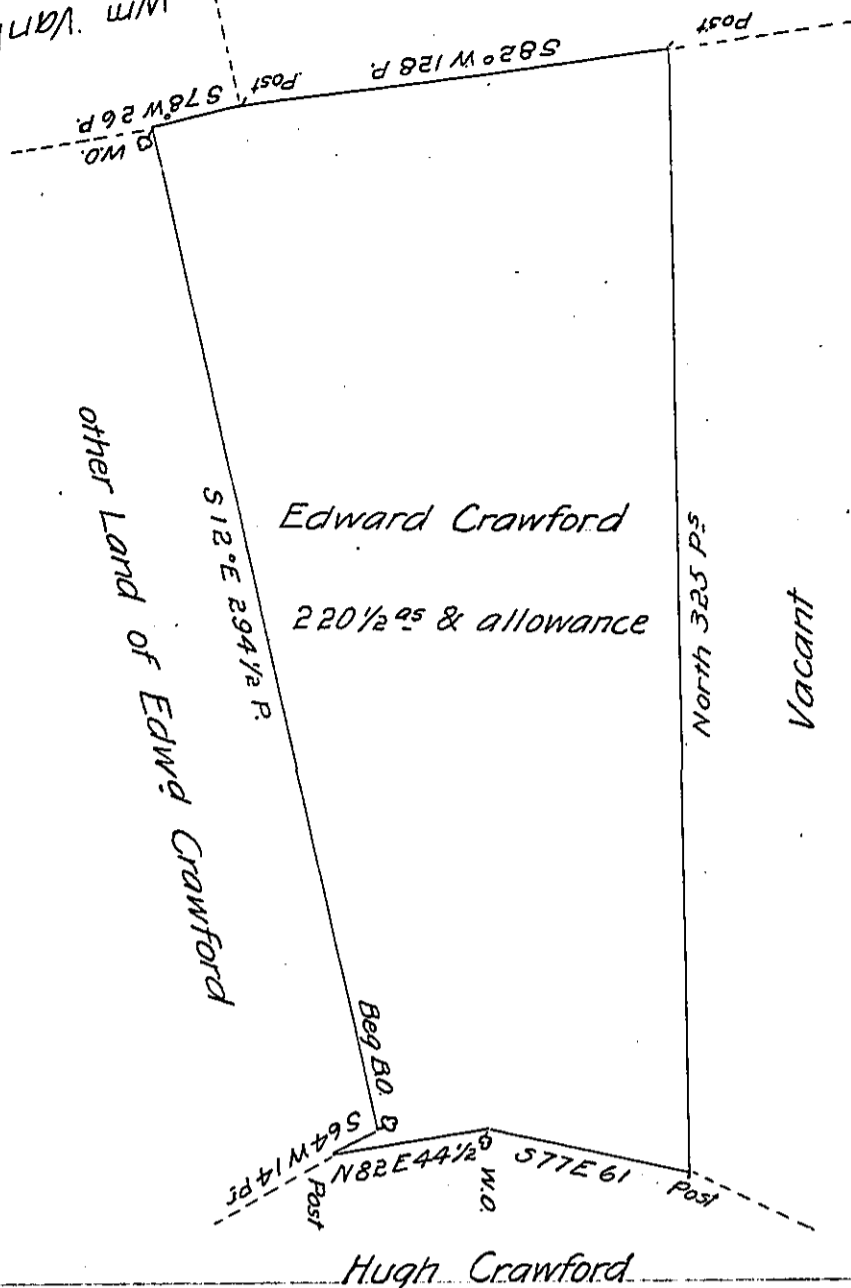

A Draught of a Tract of Land situate in Guilford Township in the County of Cumberland Containing ^{two} ~~One~~ Hundred & twenty Acres and an Half Acre and an allowance of Six Acres P. Cent for Roads &c. Survey'd July 4th 1770 in Pursuance of an Order of Survey Dated Aug^t 16th 1766 N^o 863

John Armstrong

To John Lukens Esqr
Surveyor General

D.S.

exd

IN TESTIMONY that the above is a copy of the original remaining on file in the Department of Internal Affairs of Pennsylvania, made conformably to an Act of Assembly approved the 16th day of February, 1833, I have hereunto set my Hand and caused the Seal of said Department to be affixed at Harrisburg, this twenty-third day of March 1904

James B. Brown
Secretary of Internal Affairs.